

**This electronic collection of documents is provided  
for the convenience of the user  
and is Not a Certified Document –**

**The documents contained herein were originally issued  
and sealed by the individuals whose names and license  
numbers appear on each page, on the dates appearing  
with their signature on that page.**

**This file or an individual page  
shall not be considered a certified document.**

STATE OF NORTH CAROLINA  
DIVISION OF HIGHWAYS

PROJ. REFERENCE NO.	SHEET NO.
17BP.14.R.44	X-1A
HENDERSON COUNTY CULVERT #440314	

**INDEX OF SHEETS**

SHEET NUMBER	SHEET
X-1A	INDEX OF SHEETS & SUMMARY OF CROSS SECTIONS
X-1 THRU X-2	L- CROSS-SECTIONS

**SUMMARY OF CROSS SECTIONS**

LOCATION	UNCLASSIFIED EXCAVATION (Cubic Yard)	EMBANK. +% (Cubic Yard)
-L- STA. 11 + 34.00	0	0
-L- STA. 11 + 50.00	3	1
-L- STA. 12 + 00.00	18	6
-L- STA. 12 + 50.00	8	24
-L- STA. 13 + 00.00	0	43
-L- STA. 13 + 50.00	1	64
-L- STA. 14 + 00.00	13	43
-L- STA. 14 + 03.00	1	0

Approximate quantities only. Unclassified Excavation, Borrow Excavation, Shoulder Borrow, Fine Grading, Clearing and Grubbing, Breaking of Existing Pavement, and Removal of Existing Pavement will be paid for at the contract lump sum price for "Grading".

8/23/99

5/30/2017  
P:\...of...g...corp...ate...gonnet...fleming.com\FPW02\Documents\Projects\440314\Roadway\Proj\B440314\_Rdy...xp...dgn  
Deb Wright

8/23/99

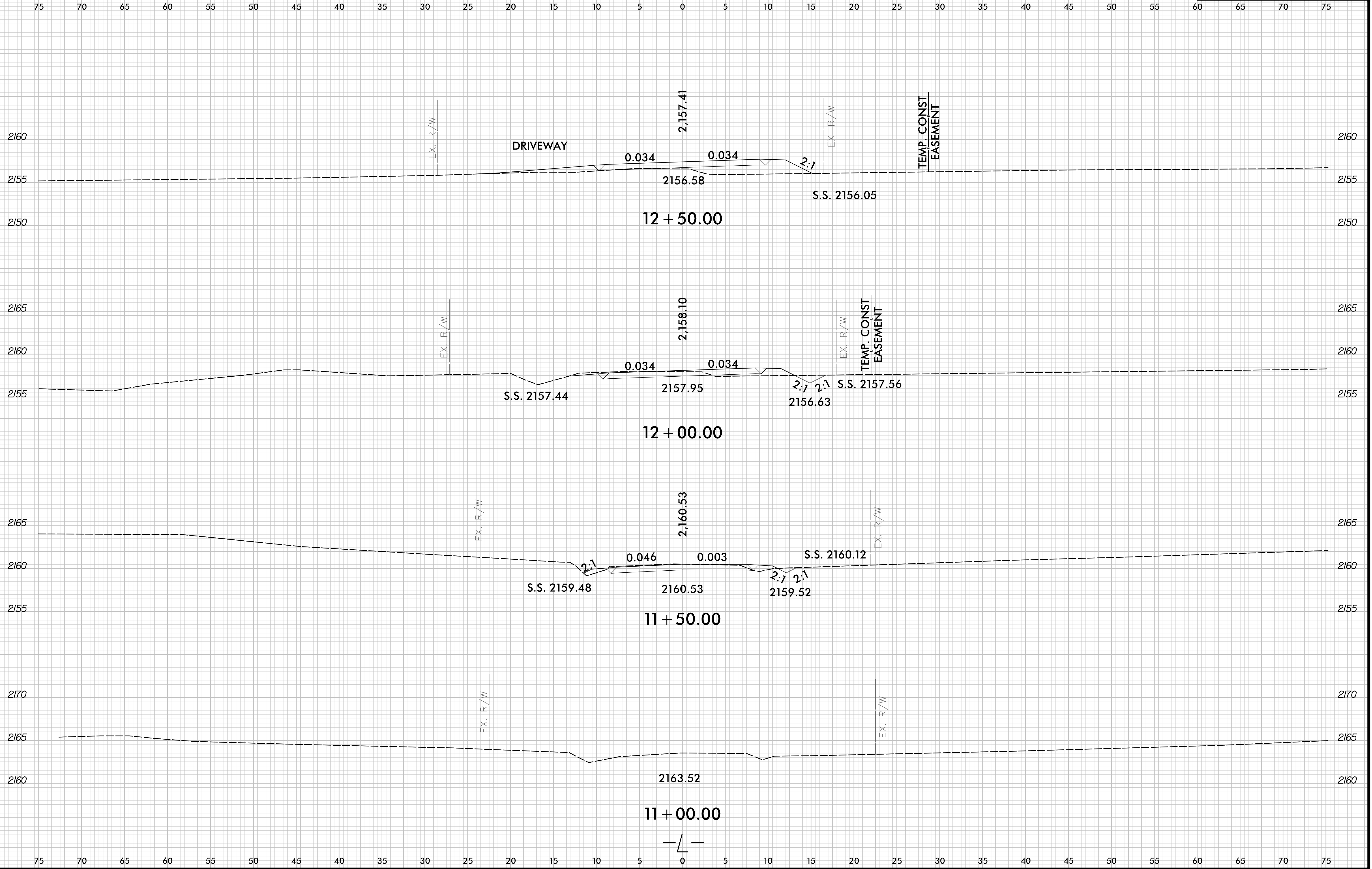

5/30/2017  
P:\...fleming\corporate\gonnet\flaming.com\FW02\Documents\Projects\57719\440314\Roadway\Pro\B440314\_Rdy\_xp1.dgn  
Deb Wright

8/23/99

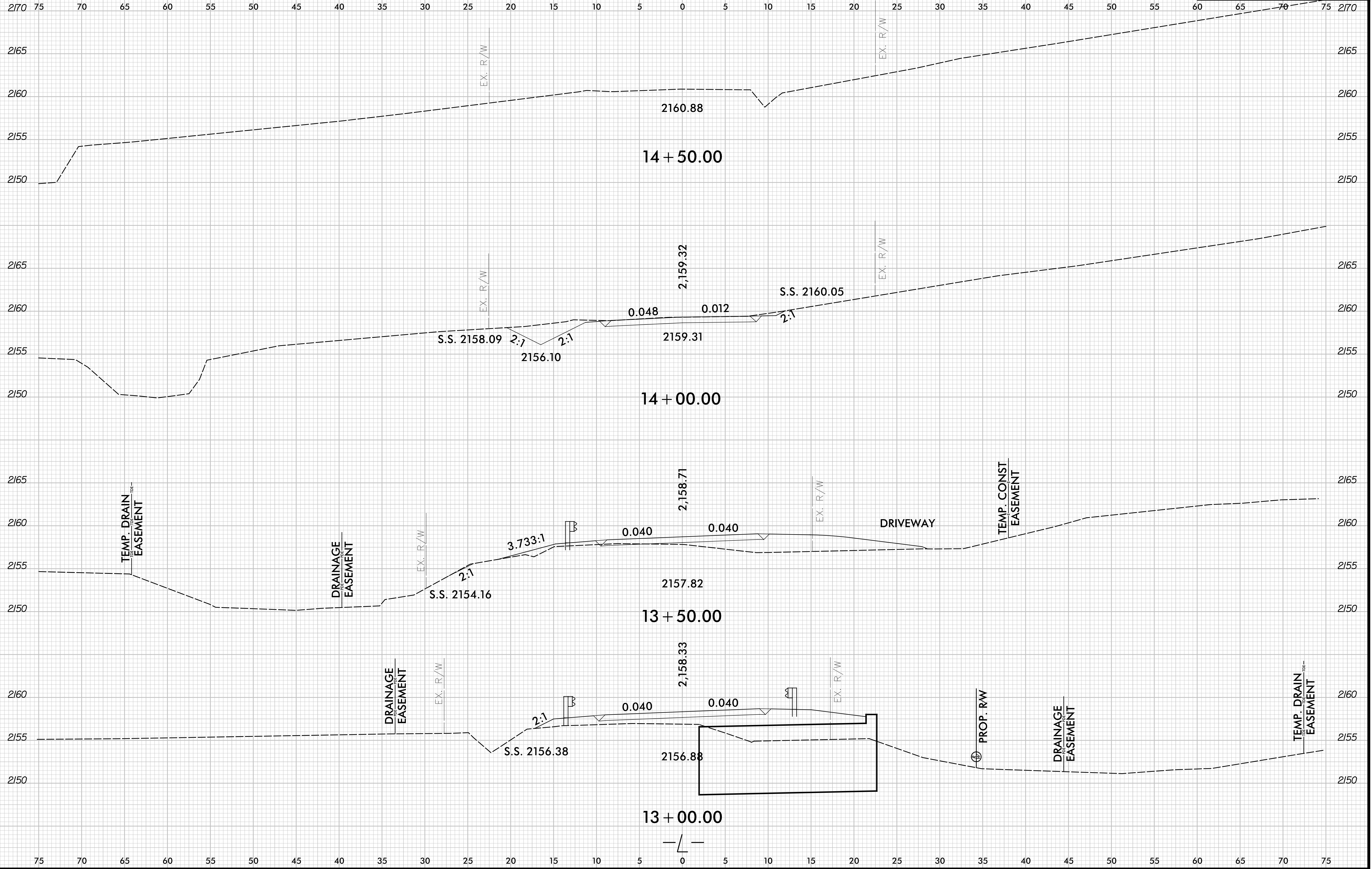

5/30/2017  
P:\of\pawing02\corporate\gannett\flaming.com\FW02\Documents\Projects\440314\Roadway\Proj\B440314\_Rdy\_xpl.dgn  
Deb Wright